

Finally fresh air.

Technical product information

refresh fresh air systems with heat recovery for refurbishment





Pluggit extract air inlet

Exhausted, damp-laden air is continuously led into the heat recovery ventilation unit and safely from here out of the house.



Pluggit PluggFlex duct

The sound-absorbing supply and extract air ducts are installed in a space-optimized ring along the ceiling in the central corridor.

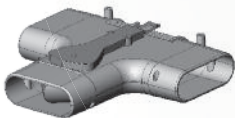

Pluggit distribution module

The supply and extract air is led into and from the corresponding rooms through the T-shaped distribution module. The air volume can be preset individually. Cleaning can be carried out effortlessly due to access panels in the T-piece.



Pluggit bow

The bows sideways are used for the corner joint PluggFlex ducts.

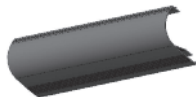

Pluggit cover profile

Almost invisible integration of PluggFlex ducts in the ceiling construction. Simple lowering of the designer click cover profile allows cleaning.



Pluggit iQoanda-air outlet

The treated air (supply air) flows through supply air outlets, which are positioned close to the ceiling (Qoanda effect), and distributed evenly and without draughts. Sophisticated technology allows the individual direction of the airflow.



The Pluggit refresh fresh air systems with heat recovery for refurbishment at a glance



Pluggit outer wall hood

There is only one exterior wall opening required. The outer cover is a combination of outside and extract air.

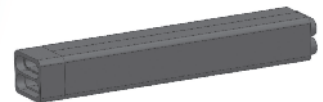

Pluggit IsoPlug Compact

No additional insulation of external and external air pipes required thanks to IsoPlug Compact. The IsoPlug Compact is directly connected to the outer wall hood and prevents unwanted heat loss and condensation.

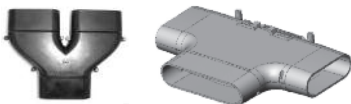

Pluggit Y- or T-piece

For optimum air distribution, the air from the device is led directly through these moulded parts and into the air ducts.







Pluggit air handling unit



The slim space-saving air handling unit is, for example, placed above kitchen cabinets and can be integrated visually by fitting a covering panel on site. In accordance with the principle of heat recovery, the fresh air is pre-heated in an energy-efficient manner via a heat exchanger using the exhaust air, and ensures a pleasant indoor climate and energy conservation.

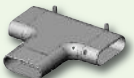
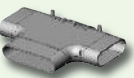





■ Outdoor air ■ Supply air (e.g. bedroom, living and children's rooms) ■ Extract air (e.g. kitchen, bathroom and WC) ■ Exhaust air

Air handling units	AR100	AR100U
		
Description	The fresh air handling unit AR100 ensures the central, regulated ventilation of refurbished apartments. The air handling unit may only be mounted horizontally.	The fresh air handling unit AR100U ensures the central, regulated ventilation of refurbished apartments. The air handling unit may be mounted horizontally or vertically.
Living area	75 m ²	75 m ²
Heat Recovery	> 90 %	> 90 %
Mounting	horizontal	horizontal, vertical
Mounting options air handling unit	Kitchen, bathroom, WC, storage rooms	Kitchen, bathroom, WC, storage rooms
Airflow volume	50 – 130 m ³ /h	50 – 130 m ³ /h
max. air capacity	100 m ³ /h at 100 Pa	100 m ³ /h at 100 Pa
Cross-counter-current heat exchanger	aluminium	aluminium
Direct current ventilators	2 pieces, radial bent backwards	3 pieces, radial bent backwards
Power consumption	30 Watt (100 m ³ /h, 100 Pa)	30 Watt (100 m ³ /h, 100 Pa)
Speed regulation	3-stage, can be pre-set	3-stage, can be pre-set
Connection NV	PK200 (172 x 75 mm)	PK200 (172 x 75 mm)
Condensed water drain	1/2 inch	1/2 inch
Material	steel sheeting, painted white	steel sheeting, painted white
Supply voltage	230 V/50 Hz	230 V/50 Hz
Protection class	IP44	IP44
Filter class G4	standard	standard
Filter class F5	optional	optional
Filter class F7	optional	optional
Certificates	DIBt*, Ö-Norm	DIBt*, Ö-Norm
CleanSafe	✓	✓
Remote control	✓ (attached by cable)	✓ (attached by cable)
Length	1,190 mm	1,190 mm
Width	248.4 mm	248.4 mm
Height	360 mm	360 mm
Weight	30 kg	30 kg

* submitted
 Subject to errors. Please refer to the technical handbook for technical data.

Supply and extract air	RVT150	TS150-150-150	TS150-200-150	TSS150-200-150	YS200-150-150	RK0150	REV150
							
Description	Distributor module for PK150 with adjustment for volume flow	Distribution of the air stream of supply and extract air using stub lines in the ring (alternative Y-piece)	Distribution of the air stream of supply and extract in the ring	T-piece lateral for PK150/ PK200	Y-piece from connecting piece PK200 onto 2 x PK150	iQoanda air outlet for PK 150 with adjustment for air stream	Extract air kit for RVT150 or PK150 incl. filter
Material	ABS	ABS	ABS	ABS	ABS	ABS	ABS
Colour	black	black	black	black	black	white	white
Connection	3 x PK150	3 x PK150	1 x PK200, 2 x PK150	1 x PK200, 2 x PK150	1 x PK200, 2 x PK150	RVT150 or PK150	RVT150 or PK150
Length	221.8 mm	203.5 mm	186 mm	151.8 mm	167 mm	101.1 mm	145.5 mm
Width	233.5 mm (connection supports 103.5 mm)	233.5 mm (width connection supports 103.5 mm)	287 mm	330 mm	227.2 mm (PK150 = 103.5 mm; PK200 = 170 mm)	346 mm	213.9 mm
Height	50 mm	50 mm	50 mm	109.6 mm	48.5 mm	55.7 mm	213.9 mm

Ducts	PK150	PK200
		
Description	PluggFlex-duct PK150 for the supply and extract air to the ringsystem	PluggFlex-duct PK200 for the supply and extract air from the fresh air device to the ringsystem
Material	PP	PP
Colour	black	black
Width	113 mm	172 mm
Height	50 mm	57 mm
Supply length	25 m	10 m
Weight	400 g/m	750 g/m
Min. bending radius	0.75 m	1 m

IsoPlugg	IPC200	IPCAS	IPCAD	IPCBO	IPCBS	IPCWD	IPCWV
							
Description	Steam-tight insulating pipe for heat and sound insulation and condensation protection for external and exhaust air	IsoPlugg Compact adapter for air handling units with connection to 2 x PK200	IsoPlugg Compact adapter for manually shortened IsoPlugg Compact insulating with connection to 2 x PK200	IsoPlugg Compact vertical bow 2 x 45°	IsoPlugg Compact lateral bow 2 x 45°	IsoPlugg Compact wall duct kit	IsoPlugg Compact extension element for IPCWD
Material	EPP	EPP	EPP	EPP	EPP	EPP	EPP
Colour	black	black	black	black	black	black	black
Connection	2 x PK200	2 x PK200	2 x PK200	2 x PK200	2 x PK200	2 x PK200	2 x PK200
Length	3 x 330 mm	330 mm	100 mm	168.5 mm	165.6 mm	250 mm	50 mm
Width	198 mm	198 mm	198 mm	198 mm	198 mm	Ø 225 mm	Ø 225 mm
Height	160.6 mm	258 mm (connection to air handling unit) 160.6 mm (connection to PK200/IPC200)	160.6 mm	160.6 mm	160.6 mm	–	–

Cover elements	PPE	PPD	EAI1	EAI2	EAA1	EAA2	PVA1	PVA2
								
Description	Cover profile single for covering the distributor ring	Cover profile double for covering the distributor ring	Cover for corners, internal with a single ring	Cover for corners, internal with a double ring	Cover for corners, external with a single ring	Cover for corners, external with a double ring	Profile connector with a single ring	Profile connector with a double ring
Material	PVC	PVC	ABS	ABS	ABS	ABS	ABS	ABS
Colour	white	white	white	white	white	white	white	white
Length	2,000 mm	2,000 mm	222.2 mm	230.7 mm	149.9 mm	150.1 mm	144.5 mm	142.6 mm
Width	144 mm	144 mm	200.7 mm	214.2 mm	234 mm	231.4 mm	24 mm	24 mm
Height	87.1 mm	142.1 mm	90.1 mm	145 mm	90.1 mm	144.6 mm	87.5 mm	144 mm

End covers for stubs: ENA1 (single ring); ENA2 (double ring)

Technical product information refresh
Pluggit refresh accessories

Accessories	SD100D	SD125PK
		
Description	Silencer with direct connection to the external and extract air pipe of the AR air handling unit. Supply and extract air integrated into one.	Silencer is installed in the supply and extract air of the AR air handling unit. SD125PK is required for both supply and extract air.
Material	Galvanised steel sheeting	Closed cell pulp with flexible aluminium coating
Colour	white	silver
Connection	4 x PK200	2 x PK200
Length	504 mm	880 mm
Width	219 mm	155 (connection supports)
Height	308 mm	225 mm

The technology makes the difference.

Innovations Pluggit with added value for humans and the environment



Technology for air to be led almost silently along the ceiling and evenly distributed in the room with no draughts.



System concept with maximum flexibility for the installation of ventilation channels. Regardless of whether in screed, concrete, wood flooring or wall, floor, ceiling. The original Pluggit air channels can be used anywhere.



Energy efficiency – optimal ratio of energy expended to heat recovery degree attainment.



Almost impossible pollution potential thanks to technically smooth surfaces combined with a concerted and certified cleaning concept.



In need of some fresh air in new buildings?
The unique fresh air system for new buildings.
Details at www.pluggit.com

In need of some fresh air?

More information about the company, about the intelligent technology of the Pluggit fresh air systems for new buildings and refurbishment and information regarding references and regional contacts can be found at **www.pluggit.com** or as a dialogue at **www.lueftungsblog.de**